

BUILDING C Vocational Tech Building

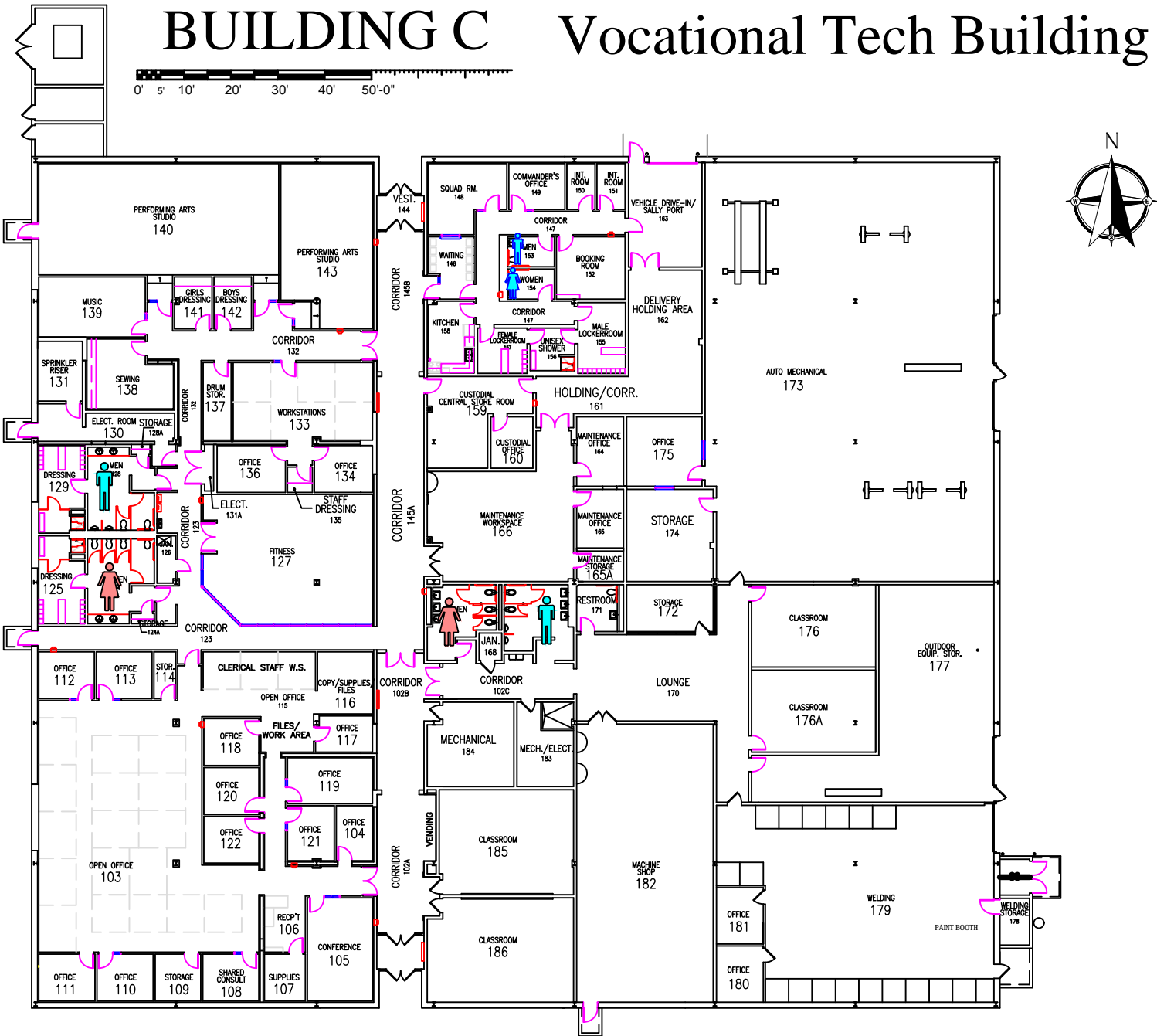

EMERGENCY STORM SHELTERS

In event of a Tornado Warning everyone should go to a **PRIMARY SHELTER**

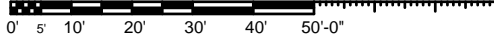
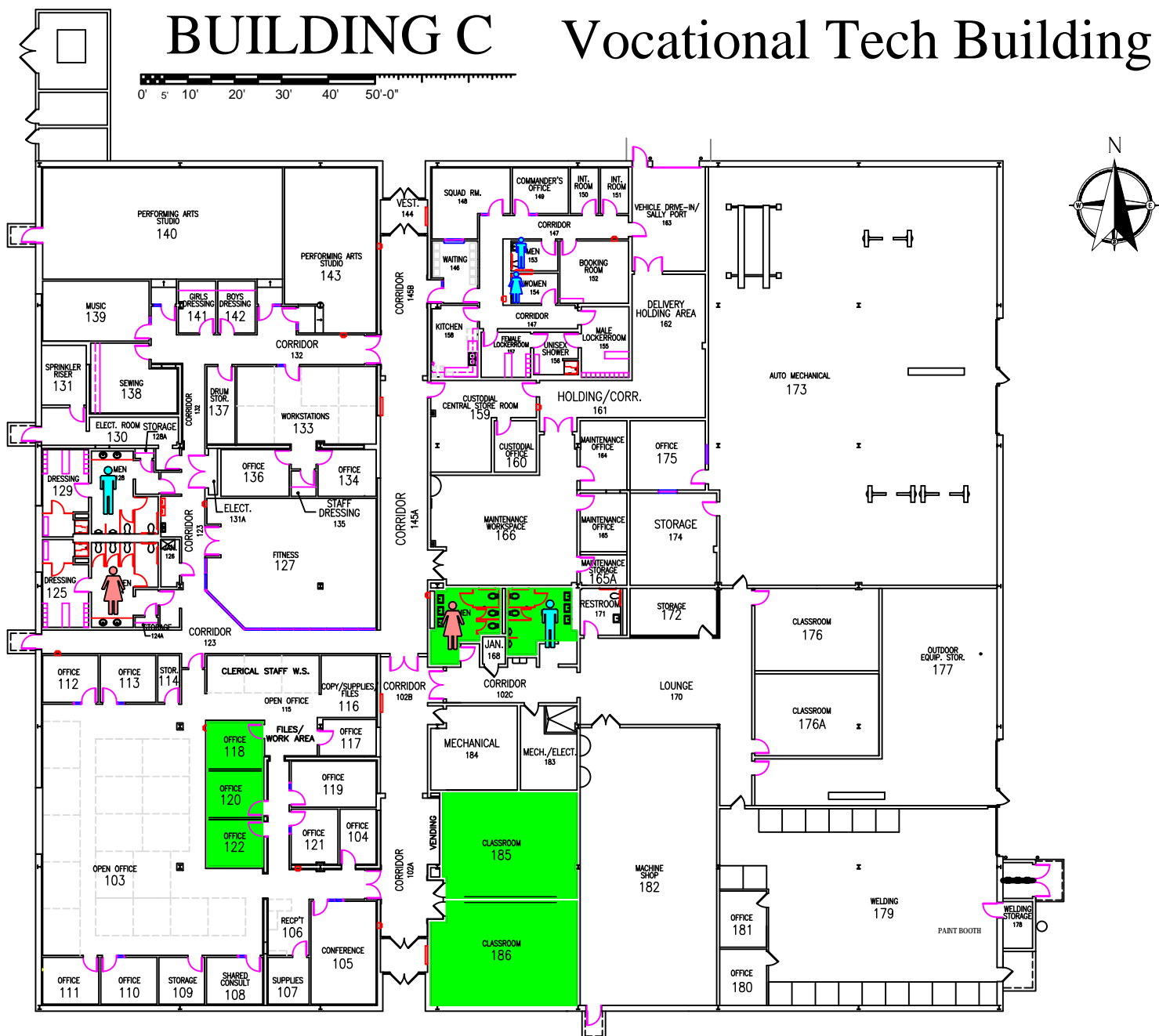

EMERGENCY EXIT PLAN

EXIT

IN CASE OF EMERGENCY USE MARKED EXITS

EXIT

BUILDING C Vocational Tech Building

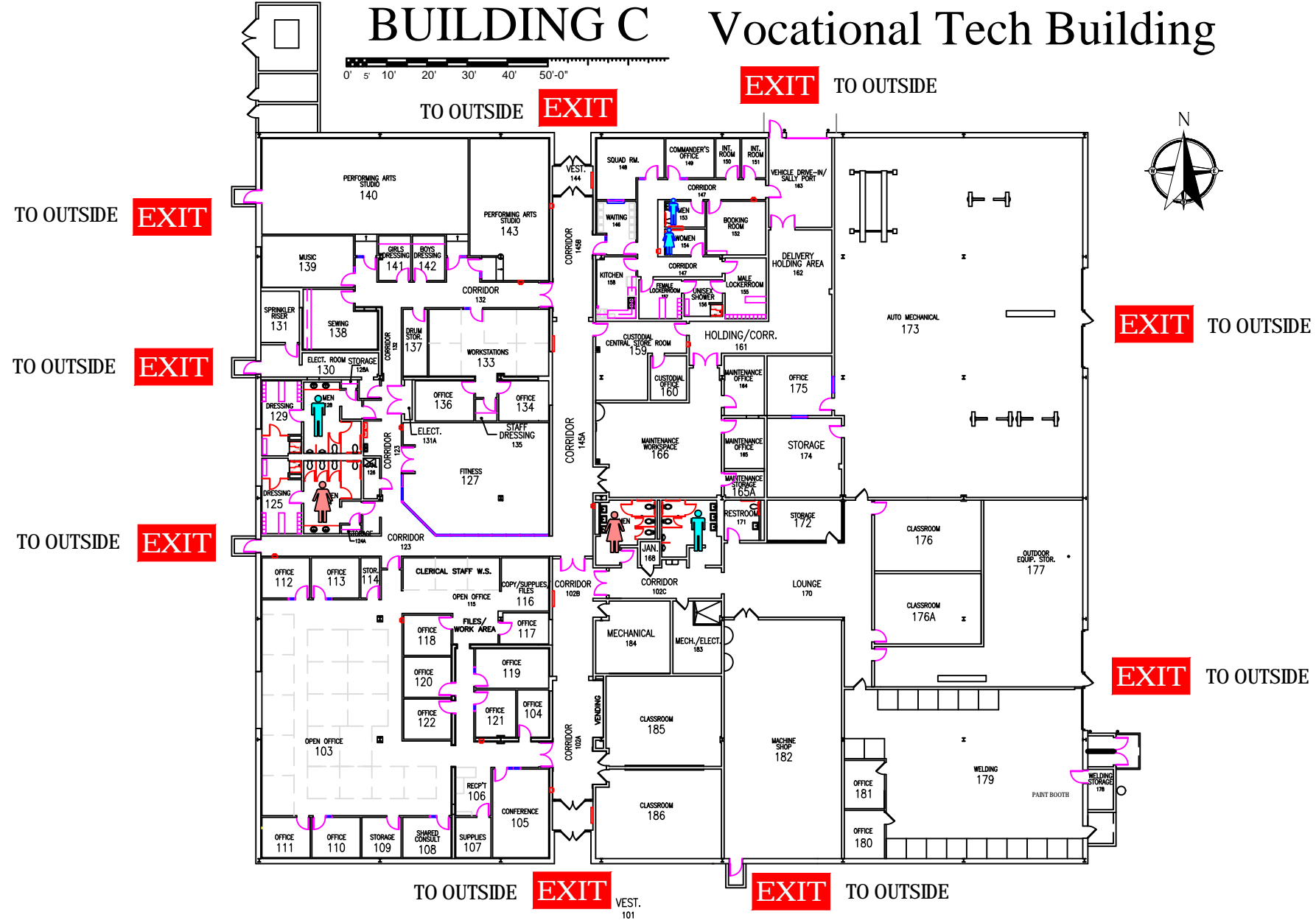
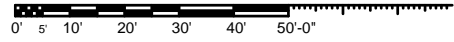

TO OUTSIDE **EXIT**

VEST.
101

EXIT TO OUTSIDE